



## **IGTF055W**

### **55cm Tall Freezer White**

**Please read these instructions carefully before use and retain for future reference.**

**Before switching on your appliance,  
always check for any damage which may have been caused in transit.**

# CONTENTS

Important Safety Instructions..... 3-5

Product Specification..... 6

Appliance Overview ..... 7

Installation..... 8-11

Operating Instructions..... 12-13

Cleaning & Maintenance ..... 14-15

Trouble Shooting Guide..... 16

Mains Plug Fuse Replacement ..... 17

Disposal Information..... 17

Igenix Warranty Information ..... 18-19

## IMPORTANT SAFETY INSTRUCTIONS

**Read and follow all the instructions even if you feel you are familiar with the product and find a place to keep this manual handy for future reference.**



**WARNING:** This product is intended for domestic use only; to store and freeze food products only. When using electrical appliances, basic safety precautions should always be followed:

- Do not operate the appliance with a damaged cord or plug, after it malfunctions or has been dropped or damaged in any way. All electrical repairs must be carried out by an electrician. Inadequate repairs may result in a major source of danger for the user and invalidate the warranty.
- Check the voltage of the appliance matches the household voltage, which is located on the rating label.
- Use of an extension cord is not recommended with this product.
- The appliance can be used by persons with reduced physical, sensory, or mental capabilities or lack of experience and knowledge, if they have been given supervision or instruction concerning the use of the appliance in a safe way and understand the hazards involved.
- Children should be supervised to ensure that they don't play with the appliance.
- Cleaning and user maintenance shall not be made by children.
- Keep the appliance and its cord out of the reach of children.
- Keep all packaging well away from children as there is a risk of suffocation.
- Always unplug the appliance before attempting to move. When disconnecting from the electricity supply, pull the plug and not the cord.
- This product is for indoor use only.
- Do not store explosive substances such as aerosol cans with a propellant in this appliance.
- Always keep the ventilation openings clear of obstruction. Should they

become blocked, clear them straight away.

- The refrigerant of this product is R600a which is flammable. Ensure when moving the appliance or during installation that the cooling system does not get damaged.
- Do not use mechanical devices or other means to accelerate the defrosting process.
- Do not touch the light bulb if it has been on for a long period of time because it could be very hot.
- During transportation and installation of the appliance, be certain that none of the components of the refrigerant circuit become damaged.
- Make sure that the power plug is not squashed or damaged by the back of the appliance. A squashed or damaged power plug may overheat and cause a fire.
- Do not remove or touch items from the freezer compartment if your hands are damp/wet, as this could cause skin abrasions or frost/freezer burns.
- Before disposal of the old appliance, make sure that any locking mechanisms have been broken off, doors have been removed but shelves have been left in so that children cannot easily climb inside. Also remove the plug so the appliance is unusable.



**WARNING:** The appliance is heavy and care is needed when unpacking and moving it. Get extra help and only hold the appliance by the casing – never hold by the door or the trim.



**WARNING:** Risk of child entrapment.



**WARNING:** Risk of fire/flammable materials.

- When positioning the appliance, ensure the power cord is not trapped or damaged.
- Do not locate multiple portable socket-outlets or portable power supplies at the rear of the appliance.
- Children aged from 3 to 8 years are allowed to load and unload refrigerating appliances.

- To avoid contamination of food, pay attention to the following:
  - opening the door for long periods can cause an increase of the temperature in the compartments of the appliance;
  - clean regularly surfaces that can come in contact with food and accessible drainage systems;
  - clean water tanks if they have not been used for 48 hours; the water system connected to a water supply if water has not been drawn for 5 days;
  - store raw meat and in suitable containers in the freezer so that it is not in contact with and cannot drip onto other food;
  - two-star frozen-food compartments are suitable for storing pre-frozen food, storing or making ice-cream and making ice cubes;
  - one-, two- and three-star compartments are not suitable for the freezing of fresh food;
  - if the refrigerating appliance is left empty for long periods, switch off, defrost, clean, dry and leave the door open to prevent mould developing within the appliance.

## PRODUCT SPECIFICATION

Model:	IGTF055W
Product Dimensions (mm)	H:1420 x W:550 x D:550
Frozen Food Storage Volume	160L
Climate Class	N/ST
Energy Consumption	183 (kWh/a)
Airbourne Acoustical Noise	42dB
Energy Rating	E
Freezing Capacity	7.2kg/24h
Rated Voltage	220-240V

## AMBIENT ROOM TEMPERATURE LIMITS

Climate Class	Symbol	Ambient Temperature °C
Extended Temperature	SN	+ 10 to + 32
Temperate	N	+ 16 to + 32
Subtropical	ST	+ 16 to + 38
Tropical	T	+16 to + 43

# APPLIANCE OVERVIEW

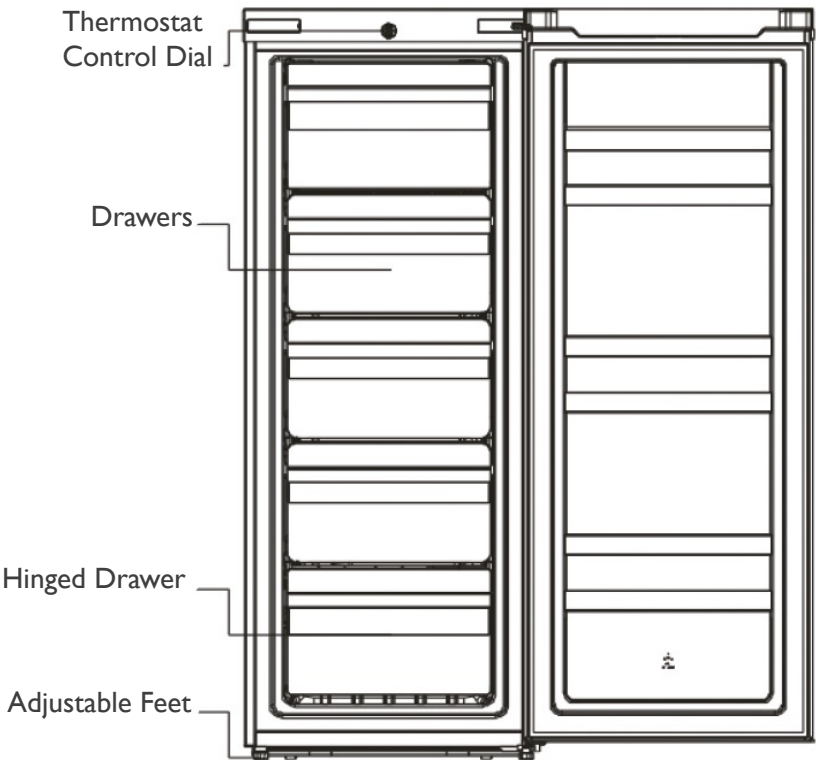

# INSTALLATION

## Location and Air Circulation

- The appliance must stand vertically on a flat, even surface. It is not recommended to stand the appliance on a carpeted surface.
- To level the appliance, use the levelling feet by turning them until the appliance is as level as possible, see the 'Levelling the Unit' section.
- The freezer should be placed indoors in a dry, well-ventilated space.
- Before use, all packing materials should be removed, including foam pads and tapes inside the freezer. Tear off protective film from the door and freezer body.
- This appliance has been designed to operate in ambient temperatures between 16°C and 38°C.
- The appliance may not operate properly at temperatures outside of this range.
- The product is designed to operate normally in the temperature range specified by its class rating. You can find the climate class on the product rating label.
- It is not recommended to place the appliance in a room where the temperature is likely to drop below 16°C for prolonged periods, as the internal appliance temperature will not be maintained.
- The appliance should be at least 50cm away from sources of heat e.g., radiators, direct sunlight, gas ovens, stoves and at least 5cm away from electric cookers, as extreme temperatures will affect the performance of the appliance.
- It is not recommended to place the appliance directly against the wall. Allow at least 10cm of clearance space between the rear of the appliance and the rear wall.
- Allow 10cm of clearance space to the sides of the appliance and 30cm above the appliance.
- It is not recommended to place the appliance next to a deep freezer, there should be at least 2cm between them to prevent humidity or condensation on the outer surface.
- Do not expose the appliance to damp conditions, open air, or rain.
- Do not place in a location where it is moist or damp or the appliance can be splashed with water.



- Do not lift the appliance by the pipes or the door when moving.
- It is not recommended to place the appliance in a wall recess, fitted cabinet or furniture, as this will not allow adequate ventilation and could be a potential fire hazard.
- Enough space should be left to be able to open the door and drawers.

## Reversing the Door

Tools required: Crosshead screwdriver, flathead screwdriver and hexagonal spanner.

1. Remove the right top-hinge cover.

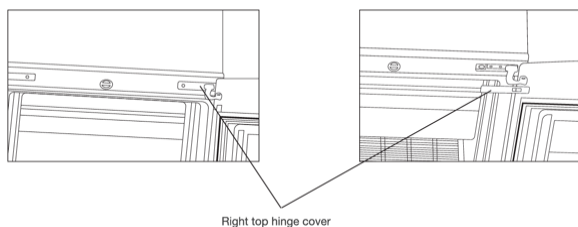

2. Remove the screws from the fixed top-hinge with the crosshead screwdriver.

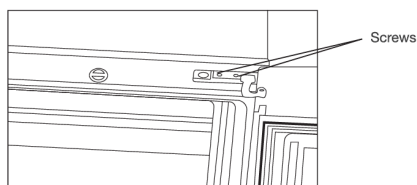

3. Replace the top-hinge, the top door limit block and the door bearing bush onto the other side as follows:
  - a. Remove the nut with sleeve. Take off the washer then remove the axes to fix to the other side.

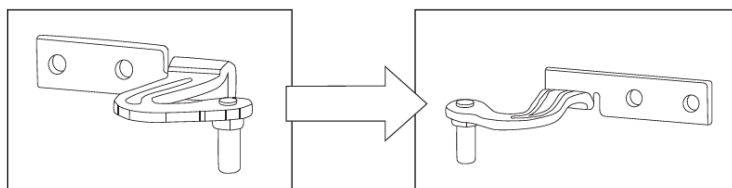

b. Remove the door limit block.

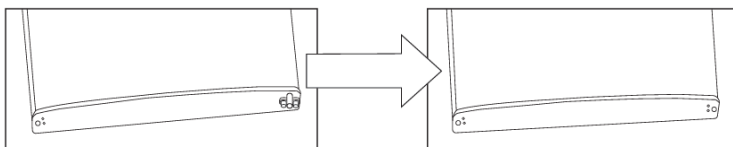

c. Take out another limit block, with screw mounting to the door.

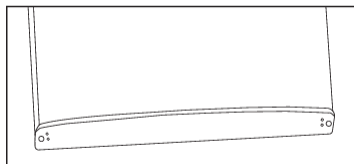

4. Disassemble the screws fixed to the bottom-hinge with the crosshead screwdriver.

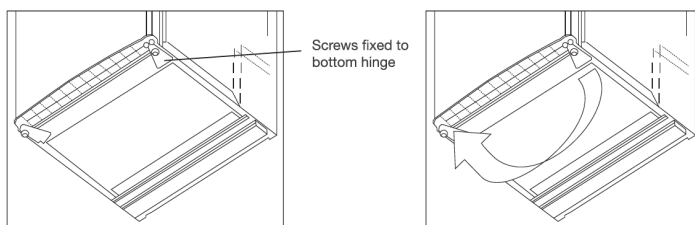

**Please note:** The freezer incline angle should be kept to less than 45°.

5. Replace the bottom hinge to the other side then fix it with screws.  
6. Set the door to the right position, fix the mid-hinge.

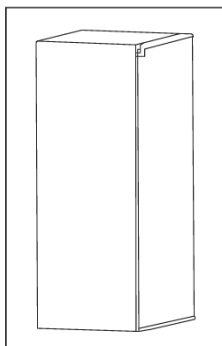

7. Replace the top-hinge.

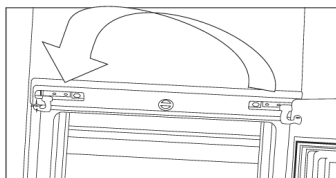

8. Set the top door to the right position, fix the top hinge and the cover.



9. Replace the leveller to the other side and adjust it to make sure the unit is level.

#### Door Space Requirements:

The unit door must be able to open fully as shown to the right.  $W \times D > 902 \times 1052\text{mm}$

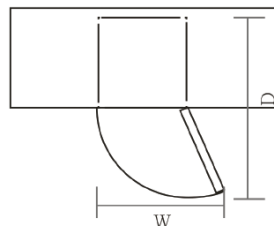

#### Levelling the Unit

If the unit is not level, the door and magnetic seal alignments will not enclose properly.

**Caution:** Before adjusting the levelling feet, the freezer should be disconnected from the power. Precautions should be taken to prevent any personal injury.

To adjust levelling feet:

- Turn the feet clockwise to raise the freezer.
- Turn the feet counter anticlockwise to lower the freezer.
- Adjust the right and left feet based on the procedures above until the appliance is as level as it can be.

# OPERATING INSTRUCTIONS

## Using the Appliance

- The thermostat dial is located on the top middle of the freezer interior.
  - Min: Warmest Temperature
  - Mid: Normal Operation (adequate for most situations)
  - Max: Coolest Temperature
- During high ambient temperatures e.g. On hot summer days. It may be necessary to set the thermostat to the coolest setting (Max). This may cause the compressor to run continuously to maintain a low temperature in the cabinet.
- For the first time you install your freezer, set the thermostat dial to “Mid”. Give your freezer time to cool down completely before adding food. It is the best to wait 24 hours before adding food.

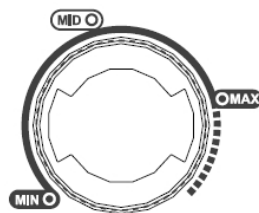

## Noises Inside the Appliance

You may notice that your unit makes some unusual noises. Most of these are perfectly normal, but you should be aware of them. These noises are caused by the circulation of the refrigerant liquid in the cooling system. It has become more pronounced since the introduction of CFC free gases. This is not a fault and will not affect the performance of your unit. This is the compressor motor working, as it pumps the refrigerant around the system.

## Storing Food in the Appliance

- Cooked meats/fishes should always be stored separate to raw meats/fishes to avoid bacterial transfer. Keep raw meats/fishes in a container that is large enough to collect juices and cover it properly.
- Leave space around your food, to allow air to circulate inside the unit. Ensure all parts of the unit are kept cool.
- To prevent transfer of flavours and drying out, pack or cover the food separately.
- Always let pre-cooked food cool down before you put it in the unit. This will help to maintain the internal temperature of the unit.

- To prevent cold air escaping from the unit, try to limit the number of times you open the door. We recommend that you only open the door when you need to put food in or take food out.

The table below contains general guidelines on the storage of food in the freezer.

Freezer Location	Type of Food
Freezer door	<ul style="list-style-type: none"><li>• Foods with natural preservatives, such as jams, juices, drinks, condiments.</li><li>• Do not store perishable foods.</li></ul>
Freezer drawer/shelf	<ul style="list-style-type: none"><li>• Foods for long-term storage.</li><li>• Bottom drawer/shelf for raw meat, poultry.</li><li>• Middle drawer/shelf for frozen vegetables, chips.</li><li>• Top drawer/shelf for ice cream, frozen fruit, frozen baked goods.</li></ul>

## CLEANING & MAINTENANCE

- Use a vacuum cleaner to remove dust from underneath the appliance and from around the compressor which is situated at the back of the unit. Do this regularly to maintain adequate ventilation. Be careful not to damage the coolant system.
- The interior of the freezer should be cleaned regularly to avoid odour.
- Check the door gasket regularly to make sure there is no debris.
- Clean the door gasket with mild soap and water.
- Please turn off the power before cleaning, remove all food, shelves, drawers, etc.
- Use a soft cloth or sponge to clean the inside of the freezer, with two tablespoons of baking soda and a quart of warm water. Then rinse with water and wipe clean and open the door and dry it naturally before the power is turned on.
- For areas that are difficult to clean in the freezer (such as narrow sandwiches, gaps, or corners), it is recommended to wipe them regularly with a soft rag, soft brush, etc. and when necessary, combined with some auxiliary tools (such as thin sticks) to ensure no contaminant accumulation in these areas.
- Do not use soap, detergent, scrub powder, spray cleaner, etc., as these may cause odours in the interior of the freezer.
- Clean the bottle frame, shelves, and drawers with a mild detergent and dry with a soft cloth.
- Wipe the outer surface of the freezer with a soft cloth dampened with soapy water, detergent, etc., and then wipe dry.
- Do not use hard brushes, steel balls, wire brushes, abrasives, such as toothpastes, organic solvents (such as alcohol, acetone, banana oil, etc.), boiling water, acid or alkaline items clean freezer considering that this may damage the fridge surface and interior. Boiling water and benzene may deform or damage plastic parts.
- Do not rinse with water so as not to affect the electrical insulation properties.

**Please Note:** Condensation may appear on the outside of the unit. This may be due to a change in room temperature. Wipe away any moisture residue. If the problem continues, please contact a qualified technician for assistance.

## **Moving the Appliance**

Hold the unit around the sides or base when moving it. Under no circumstances should the appliance be lifted by holding the edges of the top surface.

## **Servicing**

The unit should be serviced by an authorized engineer and only genuine spare parts should be used. Under no circumstances should you attempt to repair the unit yourself. Repairs carried out by inexperienced persons may cause injury or serious malfunction. Contact a qualified service technician.

## **Long Term Non-Use**

Switch off and remove the plug from the power socket ensuring not to pull the cord. Remove any food and follow the cleaning instructions in the 'Cleaning and Maintenance' section. Leave the door ajar as this will prevent odours and mould from accumulating and will allow the appliance to dry completely.

## TROUBLE SHOOTING GUIDE

If you experience difficulties with the appliance, please check the suggestions below before contacting customer services on 01473 271272:

Problem	Possible Cause	Solution
The appliance does not work.	Mains plug is not plugged in or is loose.	Insert mains plug firmly.
	Fuse has blown or is defective.	Check fuse, replace if necessary.
	Socket is defective.	Mains malfunctions are to be corrected by an electrician.
The appliance is performing poorly.	The appliance has been overloaded.	Remove some food items from the appliance.
	The doors are not closed properly.	Check for any obstructions and close the doors firmly.
	There is not enough ventilation around the unit.	Make sure the unit is positioned as per the installation instructions.
The temperature in the appliance is too cold.	The temperature is set too low.	Turn the thermostat to a warmer setting.
The temperature in the appliance is too warm.	The thermostat is set too high.	Turn the thermostat to a colder setting.
The appliance is making a lot of noise.	The appliance is touching the wall or other objects.	Move the appliance slightly, so it does not touch the wall.
	The appliance has not been levelled properly.	Adjust the feet at the front of the fridge, ensuring they are in firm contact with the floor.
There is water in the lower part of the freezer.	The drain hole is clogged.	Use the defrost drain plug to clean the drain hole.



## MAINS PLUG FUSE REPLACEMENT

### Fuse Replacement (Class I)

This appliance must be earthed. Remove the fuse cover with a small flat head screw driver. Take out the fuse and replace with a new fuse of the same Amp. Replace the fuse cover and push back into place.



## DISPOSAL INFORMATION

The European Directive 2012/19/EU on Waste Electrical and Electronic Equipment (WEEE), requires that old household electrical appliances must not be disposed of in normal unsorted municipal waste.

Old appliances must be collected separately in order to optimise the recovery and recycling of the materials they contain and reduce the impact on human health and the environment.

The crossed out “wheeled bin” symbol on the product reminds you of your obligation, that when you dispose of the appliance it must be separately collected. Consumers should contact their local authority or retailer for information concerning the correct disposal of their old appliance.



## Igenix Warranty Terms & Conditions

This product is guaranteed for a period of 12 months as standard from the date of purchase against mechanical and electrical defects. You can extend your warranty for a further 12 months by registering your product.

Upon registration we will cover your product for a period of 24 months from the original purchase date against any mechanical or electrical defects.

To qualify for the warranty, the product must be used for domestic household use only and in accordance with the instructions in the user manual. Any misuse of the product will result in the warranty being void.

The warranty does not cover accidental damage, misuse, neglect, tampering or incorrect adjustment or installation.

The warranty will be rendered invalid if the product is resold, has had its serial number removed (or has an invalid serial number), or if an unauthorised person has carried out any repairs or alterations.

The warranty does not cover accessories or consumable parts that require replacement under normal use. This includes shelving, dials, filters, belts and trays etc.

In the unlikely event of a breakdown please refer to the Troubleshooting guide in your user manual and check all plugs, fuses and the electricity supply.

If you still require assistance please contact our Customer Service department on **01473 271 272** or write to us at the following address:

**Customer Service Department  
38 Bluestem Road, Ransomes Europark  
Ipswich, IP3 9RR**

Please quote the Product Code which begins 'IG' or 'DF' and the PO Number on the rating label on the appliance, and give details of the exact fault. We will then decide whether to repair or replace the item.

Before we arrange the repair or replacement you will be required to return a copy of your proof of purchase. Please retain your original.

If an item is replaced within the agreed warranty period, the warranty for the replacement item will be calculated from the purchase date of the original.

In the event that the product is inspected and no fault is found or the product is not within the warranty period you will be charged for the repair and any carriage costs.



## **Thank you for choosing Igenix**

As a valued customer we would like to offer you a FREE 2 year warranty to cover your product against any electrical or mechanical defects.

This means that in the unlikely event you develop a fault or problem with your product we will happily repair or replace the item free of charge.

To qualify for the 2 year warranty you must register your product within 30 days of purchase. The full Terms & Conditions of our warranty policy are shown on the opposite page. They are also available on our website. **[www.igenix.co.uk](http://www.igenix.co.uk)**



UK: 38 Bluestem Road, Ransomes Europark, Ipswich, IP3 9RR

EU: Castle Electrical Factors Ltd., Dundalk, A91 KA9R, IR

Tel. 01473 271 272

Disclaimer: Igenix operate a policy of continual improvement and development.  
We therefore reserve the right to change/alter the specification and appearance of our appliances without prior notice.  
All diagrams and images shown in this manual are for illustration purposes only.