

## 55cm Under Counter Larder Fridge



## IG255W / IG255B

**Please read these instructions carefully before use and retain for future reference.**

**Before switching on your appliance,  
always check for any damage which may have been caused in transit.**

## CONTENTS

Important Safety Instructions.....	3-5
Specification .....	6
Appliance Overview .....	7
Installation.....	7-9
Operating Instructions.....	10
Cleaning and Maintenance .....	11-13
Trouble Shooting Guide.....	14
Fuse Replacement .....	15
Disposal Information.....	16
Igenix Warranty Terms & Conditions .....	17-18

## IMPORTANT SAFETY INSTRUCTIONS

**Important:** This appliance is not intended for use by persons including children with reduced physical, sensory or mental capabilities, or lack of experience and knowledge, unless they have been given supervision or instruction concerning use of the appliances by a person responsible for their safety.

- This product is intended to be used in a household and similar applications such as: staff kitchen areas in shops, offices and other working environments;
  - farm houses and by clients in hotels, motels and other residential type environments;
  - bed and breakfast type environments;
  - catering and similar non retail applications.
- Do not use mechanical devices or other means to accelerate the defrosting process, other than those recommended by the manufacturer.
- Do not use electrical appliances inside the food storage compartments of the appliance, unless they are recommended by the manufacturer.
- Do not store explosive substances such as aerosol cans with a flammable propellant in this appliance.
- Ensure that the electricity supply in your home is rated at 220 - 240 volts before operating the appliance.
- Do not use the appliance if there is any damage to the power cord.
- Use of an extension cord is not recommended with this product.
- This product is for indoor use only.
- Keep packaging material out of the reach of children, as there is a risk of suffocation.
- Always unplug the appliance before attempting to move it.
- Children should be supervised to ensure that they do not play with the appliance.
- Ensure that the refrigerant circuit is not damaged.
- The refrigerant of this product is R600a which is flammable.
- Ensure when moving the appliance or during installation that the cooling system does not get damaged.
- **DANGER: Risk of child entrapment**
  - Before you dispose of your old refrigerator or freezer, remove the doors

and leave the shelves in place so that children cannot easily climb inside.

- When disposing of the appliance, remove the plug so the appliance is unusable.

**IMPORTANT:** Always allow 12 hours before turning on the refrigerator to allow the coolant gases time to settle after the refrigerator is in place.

**Packaging:** The cardboard packaging is recyclable and should be disposed of according to local regulations. Keep the packaging materials out of the reach of children.

Before installation take care to remove all cardboard or other packaging, including material from the condenser tubes and any material surrounding the motor / compressor unit.



**WARNING:** Risk of fire / flammable materials.

- When positioning the appliance, ensure the supply cord is not trapped or damaged.
- Do not locate multiple portable socket-outlets or portable power supplies at the rear of the appliance.
- Children aged from 3 to 8 years are allowed to load and unload refrigerating appliances.
- To avoid contamination of food, pay attention to the following:
  - Opening the door for long periods can cause a significant increase of the temperature in the compartments of the appliance;
  - clean regularly surfaces that can come in contact with food and accessible drainage systems;
  - clean water tanks if they have not been used for 48 hours; flush the water system connected to a water supply if water has not been drawn for 5 days;
  - store raw meat and fish in suitable containers in the refrigerator so that it is not in contact with or cannot drip onto other food;
  - two-star frozen-food compartments are suitable for storing pre-frozen food, storing or making ice-cream and making ice cubes;
  - one-, two- and three-star compartments are not suitable for the freezing of fresh food;
  - if the refrigerating appliance is left empty for long periods, switch off, defrost, clean, dry and leave the door open to prevent mould developing within the appliance.

The table below contains general guidelines on the storage of food in refrigerated appliances.

<b>Refrigerator location</b>	<b>Type of food</b>
Fridge door	<ul style="list-style-type: none"><li>• Foods with natural preservatives, such as jams, juices, drinks, condiments.</li><li>• Do not store perishable foods.</li></ul>
Crisper bin (salad bin)	<ul style="list-style-type: none"><li>• Fruits, herbs and vegetables should be placed separately in the crisper bin.</li><li>• Do not store bananas, onions, potatoes, garlic in the refrigerator.</li></ul>
Fridge shelf – bottom chiller bin	<ul style="list-style-type: none"><li>• Raw meat, poultry, fish (for short-term storage).</li></ul>
Fridge shelf – middle	<ul style="list-style-type: none"><li>• Dairy products, eggs.</li></ul>
Fridge shelf – top	<ul style="list-style-type: none"><li>• Foods that do not need cooking, such as ready-to-eat foods, deli meats, leftovers.</li></ul>
Freezer drawer/shelf	<ul style="list-style-type: none"><li>• Foods for long-term storage.</li><li>• Bottom drawer/shelf for raw meat, poultry, fish.</li><li>• Middle drawer/shelf for frozen vegetables, chips.</li><li>• Top drawer/shelf for ice cream, frozen fruit, frozen baked goods.</li></ul>

## SPECIFICATION

Supplier Name / Trade Mark	Igenix
Model Number	IG255B / IG255W
Category Type	Upright fridge
Energy Efficiency Class	E
Annual Energy Consumption	90kWh/annum
Freezing Capacity	N/A
Fridge Storage Volume (Litre) and Applicable Star Rating Compartment	131
Freezer Storage Volume (Litre)	N/A
Applicable Star Rating Compartment	N/A
Refrigeration System (Frost Free, Static, Totally No Frost)	Static
Temperature Rise Time	N/A
Climate Class	SN/N/ST
The appliance is intended to be used at an ambient temperature between “10” (lowest temperature) °C and “38” (highest temperature) °C	
Noise Emission (dB)	39(dB)
Built-in Appliance	N/A
Wine Storage Appliance	N/A
Voltage (V)	220-240V~
Wattage Power (W)	40W
Frequency (Hz)	50Hz
Power Source	AC

### Ambient Room Temperature Limits

Class	Symbol	Ambient average temperature °C
Extended temperature	SN	+10 to +32
Temperature	N	+16 to +32
Subtropical	ST	+16 to +38
Tropical	T	+16 to +43

## APPLIANCE OVERVIEW

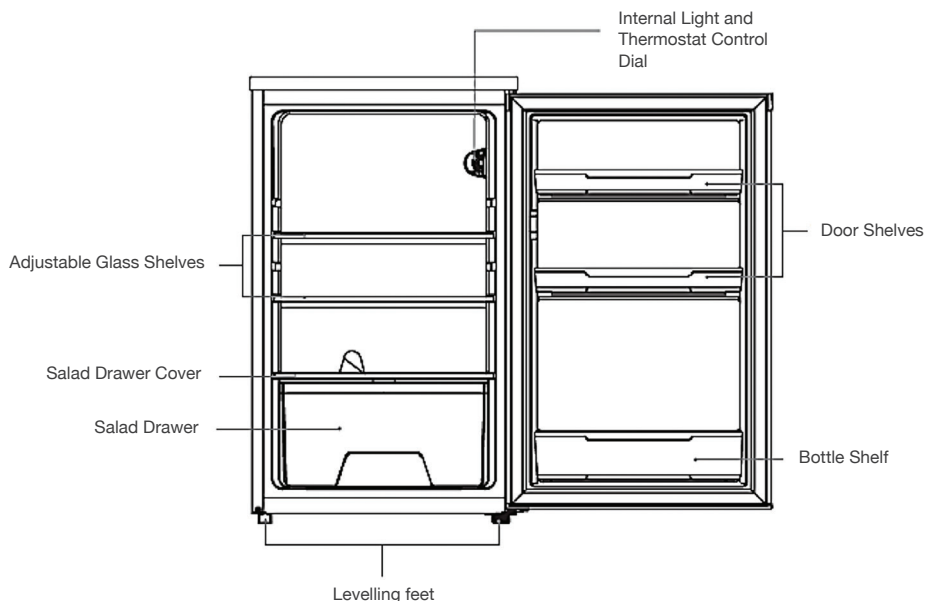

## INSTALLATION

### Location and Air Circulation

- The appliance must stand vertically on a flat, even surface, to level the appliance use the levelling feet by turning them until the appliance is as level as possible.
- This appliance has been designed to operate in ambient temperatures between 10°C and 38°C.
- It is not recommended to stand the appliance on a carpeted surface.
- It is not recommended to place this appliance in a room where the temperature is likely to drop below 5°C for prolonged periods, as the internal appliance temperature will not be maintained.
- The appliance should not be placed near sources of heat e.g. cookers, radiators, direct sunlight or in any unheated rooms e.g. garages, or outhouses, as extreme temperatures will affect the performance of your appliance.
- Do not expose the appliance to damp conditions, open air or rain.
- Do not lift the appliance by the pipes or the door when moving.
- Allow 25mm of clearance space at the sides of the appliance and 20mm above the appliance.

- It is not recommended to place the appliance directly against the wall, allow at least a 15mm clearance space at the rear.
- Do not place the appliance in a wall recess, fitted cabinet or furniture as this will not allow adequate ventilation and cause a potential fire hazard.

Providing you follow the recommended ventilation requirements you will:

- Increase the life of the appliance.
- Minimise the risk of condensation on the outside of the appliance.
- Minimise operating noises caused by vibration.

## Reverse the Door

The appliance door can be fitted to open to either the left or the right depending on its location. The appliance will have to be tilted and supported in order to carry this out. It is advisable to get some help during this procedure.

**Important:** Do not lay the appliance flat as this may damage the coolant system. Take care when fitting and tightening screws.

To change the direction of the door, please follow these instructions:

1. Ensure the appliance is unplugged and empty.
2. Remove the 2 Screws on the back of the top cover (Fig 1).
3. Lift the rear of the lid and push forward to remove from the front locators. The top hinge now is accessible (Fig 2).
4. Unscrew the top door hinge located on the top of the door and then remove the top hinge that is holding the door in place (Fig 3).
5. With help, carefully tilt the unit backwards and rest the unit on something solid to stop it slipping.

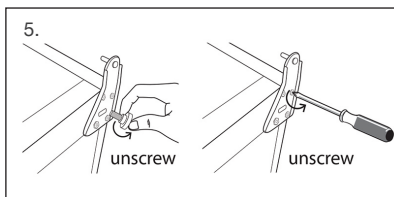
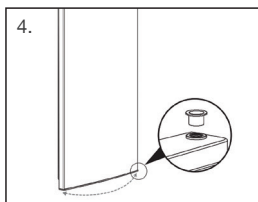
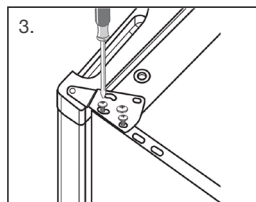
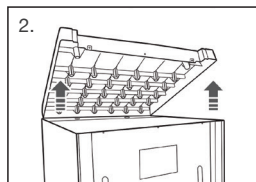
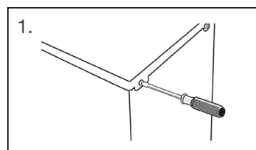



6. Lift the door off the hinge pin and place in a safe place where it will not get damaged.
7. Remove the bottom bushing and bottom bushing cap and fit them on the opposite side (Fig 4).
8. Unscrew the bottom hinge (Fig 5).
9. Remove the levelling foot and fit on the opposite side (Fig 6).
10. Screw the bottom hinge on the opposite side loosely (Fig 7).
11. Carefully slide the door on to the bottom hinge pin.
12. Screw the top hinge loosely (Fig 8).
13. Check the fridge door is aligned horizontally and vertically so that the seals are closed on all sides.
14. Tighten the top hinge. Use a spanner to tighten it if necessary (Fig 9).
15. Put the top cover back and screw it into place securely (Fig 10).
16. With the door closed, check that the door is aligned horizontally and vertically and that the seals are closed on all sides before finally tightening the bottom hinge.
17. Re-adjust the levelling feet as needed.
18. Allow 5 hours for the appliance to stand upright before turning on the appliance to allow coolant gases time to settle after the appliance is in place.

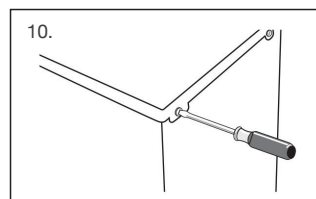
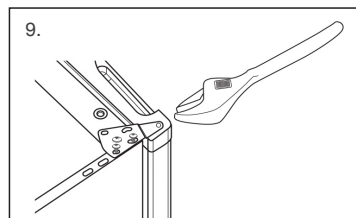
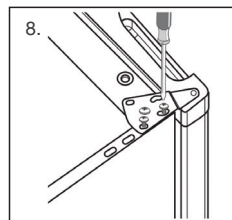

## **OPERATING INSTRUCTIONS**

- Allow 5 hours for the appliance to stand upright before turning on to allow coolant gases time to settle after the appliance is in place.
- Before placing food in the appliance turn on and wait 24 hours, this is to make sure it is working correctly and also to allow for the optimal internal temperature to be reached.
- The interior of the appliance needs to be cleaned prior to use by wiping with a soft cloth and using warm water. Wipe appliance completely dry before replacing any shelves or salad drawers.

### **Using your Appliance**

- Once dry, plug the appliance into the electricity supply.
- Adjust the temperature control which is located inside the appliance to setting 4, this is the recommended setting to use in a room with an average ambient temperature of 20°C.
- Keep the food packed, wrapped or covered.
- For hygiene reasons, always wrap food using a suitable packaging material, before storing in your appliance to avoid contact with the surface of the appliance.
- Do not place food directly against the rear wall.

### **Adjusting the Temperature**

- The internal temperature of the unit is controlled by a thermostat. The recommended position is between 1 to 4 for colder working environments (i.e. during winter) and between 5 to 6 for warmer environments. Please adjust accordingly.
- Avoid setting the thermostat too high, as this may reduce the temperature to a point where some food begins to freeze. If this happens turn down the thermostat slightly.
- The temperature inside the appliance can be monitored by using a fridge thermometer. **DO NOT USE** a Mercury filled thermometer, as a breakage would cause a health hazard.

## CLEANING AND MAINTENANCE

**WARNING:** Disconnect from the electricity supply before cleaning.

### Interior

**Note:** The interior of the refrigerator should be cleaned regularly to avoid odour.

1. Remove all food from the appliance and cover to help keep cool.
2. Remove all the shelves and salad drawer carefully from the appliance and wash in warm clean water with a soft cloth and dry thoroughly. Never replace the shelves or salad drawer into the appliance if wet.
3. Use a soft cloth or sponge to clean the inside of the refrigerator, with two tablespoons of baking soda and a quart of warm water. Rinse with water and wipe clean.
4. For areas that are difficult to clean in the refrigerator (such as narrow gaps or corners), it is recommended to wipe them regularly with a soft rag, soft brush, etc. and when necessary, combined with some auxiliary tools (such as thin sticks) to ensure no contaminant accumulation in these areas.
5. Open the door and allow the interior to dry naturally before replacing the shelves and salad drawer.
6. Plug in and switch on and allow the temperature in the appliance to drop back to an adequate temperature.
7. Replace the food in the appliance.

**Important:** Avoid getting water into the electric components of the appliance i.e. the thermostat, as this may damage your appliance.

### Exterior

- Use a clean, soft cloth dampened in soapy water to wipe the exterior surface of the appliance and dry thoroughly.
- Use a vacuum cleaner to remove dust from underneath the appliance and from around the compressor which is situated at the back of the appliance, regularly to maintain adequate ventilation. Use caution not to damage the coolant system.

**IMPORTANT:** Do not use abrasive cloths, powders, household cleaners, bleach or wax polish to clean the appliance as these can leave a smell in the appliance and can damage the exterior.

## **Door Seal**

Check the door seal regularly to make sure there are no debris. Use a clean, damp soft cloth to wipe the door seal and in between the creases, avoid damaging the door seal as this will affect the performance of your appliance.

## **Drainage Channel**

- The drainage channel must be cleaned regularly to prevent a build-up of impurities; this can be found on the interior back wall of your appliance.
- Use a damp clean cloth and wipe the channel clean, then use a pipe cleaner or similar flexible object to clean the drainage hole to prevent blockages.

## **Going Away**

If you are going away and do not want to leave the appliance left on, switch off at the mains socket and remove the plug ensuring not to pull the cord. Remove any food and follow the cleaning instructions in the “Cleaning and Maintenance” section.

**Important:** Leave the door ajar as this will prevent odours and mould accumulating in the appliance and will allow the appliance to dry completely.

## **Power Cut**

In the event of a power cut keep the appliance door closed to maintain the temperature inside.

## **Operating Sounds**

The cooling gas which circulates in the cooling circuit may make a slight noise (bubbling sound) even when the compressor is not running. Do not worry this is quite normal.

If these sounds are different check that:

- The appliance is well level.
- Nothing is touching the back of the appliance.
- The contents of the appliance is not vibrating.

## **Changing the Light**

The light is an energy efficient, long life LED. Therefore should not need replacing throughout the life of the product, however if it does, it is advised to contact a qualified technician.

1. Remove the light cover
2. Loosen the thermostat dial and fastening screw, and remove the thermostat box assembly
3. Remove the connector
4. Remove the light

## TROUBLE SHOOTING GUIDE

If you are having problems with your appliance, please use our trouble shooting guide below. If you are unable to resolve the issue using this guide please ring our Customer Service Department on 01473 271 272. Please have the model code and purchase information available.

Fault	Possible Cause	Solution
The fridge does not work.	<ol style="list-style-type: none"><li>1. Not properly plugged into the mains wall socket.</li><li>2. No electricity in the mains wall socket.</li><li>3. The door is not closed properly.</li></ol>	<ol style="list-style-type: none"><li>1. Plug in firmly.</li><li>2. Check fuse or breaker.</li><li>3. Make sure the door is properly aligned and creates a seal around the door.</li></ol>
The fridge is making a lot of noise.	<ol style="list-style-type: none"><li>1. The pipe work is touching the wall or skirting board.</li><li>2. The fridge has not been levelled properly.</li></ol>	<ol style="list-style-type: none"><li>1. Pull the fridge forward so it does not touch the wall or skirting board.</li><li>2. Adjust the feet at the front of the fridge, ensuring they are in firm contact with the floor.</li></ol>
The temperature in the fridge is too warm.	<ol style="list-style-type: none"><li>1. The thermostat is set too high for your environment.</li><li>2. The fridge is too close to a heat source.</li><li>3. There is not enough ventilation around the fridge.</li><li>4. The door is not closed properly.</li></ol>	<ol style="list-style-type: none"><li>1. Turn the thermostat to a higher setting.</li><li>2. Move the fridge away from the heat source and out of direct sunlight.</li><li>3. Ensure there is a minimum gap of 25mm at each side and 20mm above the fridge.</li><li>4. Ensure that the door is properly closed and the seal is not damaged.</li></ol>

## MAINS PLUG FUSE REPLACEMENT

### Fuse Replacement (Class I)

This appliance must be earthed. Remove the fuse cover with a small flat head screw driver. Take out the fuse and replace with a new fuse of the same Amp. Replace the fuse cover and push back into place.



## DISPOSAL INFORMATION

The European Directive 2012/19/EU on Waste Electrical and Electronic Equipment (WEEE), requires that old household electrical appliances must not be disposed of in normal unsorted municipal waste.

Old appliances must be collected separately in order to optimise the recovery and recycling of the materials they contain and reduce the impact on human health and the environment.

The crossed out “wheeled bin” symbol on the product reminds you of your obligation, that when you dispose of the appliance it must be separately collected. Consumers should contact their local authority or retailer for information concerning the correct disposal of their old appliance.





## Igenix Warranty Terms & Conditions

This product is guaranteed for a period of 12 months as standard from the date of purchase against mechanical and electrical defects. You can extend your warranty for a further 12 months by registering your product.

Upon registration we will cover your product for a period of 24 months from the original purchase date against any mechanical or electrical defects.

To qualify for the warranty, the product must be used for domestic household use only and in accordance with the instructions in the user manual. Any misuse of the product will result in the warranty being void.

The warranty, does not cover accidental damage, misuse, neglect, tampering or incorrect adjustment or installation.

The warranty, will be rendered invalid if the product is resold, has had its serial number removed (or has an invalid serial number), or if an unauthorised person has carried out any repairs or alterations.

The warranty does not cover accessories or consumable parts that require replacement under normal use. This includes shelving, dials, filters, belts and trays etc.

In the unlikely event of a breakdown please refer to the Troubleshooting guide in your user manual and check all plugs, fuses and the electricity supply.

If you still require assistance please contact our Customer Service department on **01473 271 272** or write to us at the following address:

**Customer Service Department  
38 Bluestem Road, Ransomes Europark  
Ipswich, IP3 9RR**

Please quote the Product Code which begins 'IG' or 'DF' and the Batch Code beginning '5' and give details of the exact fault. We will then decide whether to repair or replace the item.

Before we arrange the repair or replacement you will be required to return a copy of your proof of purchase. Please retain your original.

If an item is replaced within the agreed warranty period, the warranty for the replacement item will be calculated from the purchase date of the original.

In the event that the product is inspected and no fault is found or the product is not within the guarantee period you will be charged for the repair and any carriage costs.



## **Thank you for choosing Igenix**

As a valued customer we would like to offer you a FREE 2 year warranty to cover your product against any electrical or mechanical defects.

This means that in the unlikely event you develop a fault or problem with your product we will happily repair or replace the item free of charge.

To qualify for the 2 year warranty you must register your product within 30 days of purchase. The full Terms & Conditions of our warranty policy are shown on the opposite page. They are also available on our website. **[www.igenix.co.uk](http://www.igenix.co.uk)**



# igenix

UK: 38 Bluestem Road, Ransomes Europark, Ipswich, IP3 9RR

EU: Castle Electrical Factors Ltd., Dundalk, A91 KA9R, IR

Tel. 01473 271 272

Disclaimer: Igenix operate a policy of continual improvement and development.

We therefore reserve the right to change/alter the specification and appearance of our appliances without prior notice.

All diagrams and images shown in this manual are for illustration purposes only.